



Parts selection



Correct part & completeness



Assembly & placement control



Checking the order



Color control



Function control & error control



Final test & safety for the worker



Allviss

Assistancesystem for the manual workplace

Interest aroused?

Visit the



EVT Eye Vision Technology

Gartenstraße 26, 76133 Karlsruhe, Germany

Tel.: +49 721 668 004 23 0

info@evt-web.com

www.evt-web.com



Zero error manual work

Quality assurance

Object recognition

Defect detection

DCA reading

Inspection

Measure

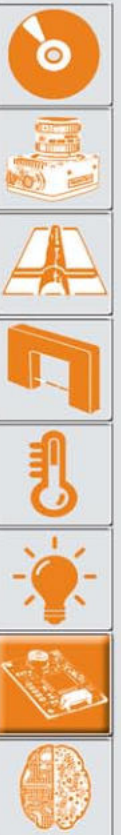

Allviss - The digital assistant

Allviss supports the employees by visualization of the work steps. Thus, at any time of the assembly, the instructions for the respective work steps are displayed. This is especially important in the case of high variant production or when training new employees. The integrated image processing software *EyeVision* enables precise inspection for optimal quality assurance.

How Allviss works

1. Allviss recognizes the component and displays it to the operator.
2. Allviss shows the steps to be taken.
3. Allviss assists the worker in his work and shows if a component has been installed correctly. It gives a visual & audible signal.
4. If the step has been completed correctly, Allviss guides the worker to the next step.
5. If a step has not been completed correctly, Allviss draws attention to the error and then checks if the error has been corrected.

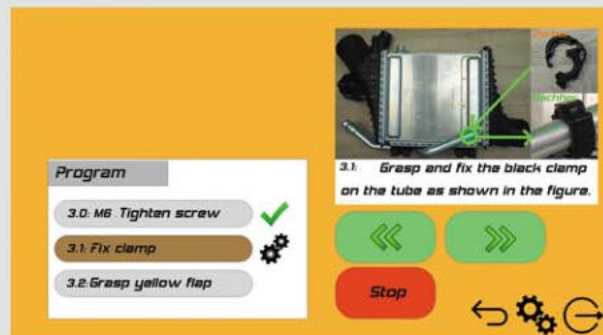

Allviss screen with process overview

The advantages of Allviss

1. 100% quality at the manual workstation
2. 0 % errors due to graphical and acoustic support
3. Early feedback in case of errors
4. Recognition of error frequencies
5. Outstanding price-performance ratio
6. High flexibility and easy adaptation



- 1 Work surface
- 2 Camera
- 3 Lighting
- 4 Touchscreen and Evaluation computer

The Integration

In addition to the integrated PLC for controlling the workstation, Allviss also has many other interfaces for integrating the manual workstation into a SCADA system (e.g. Profinet, Modbus but also OPC UA and MQTT).

Application fields of EyeVision:



Identify

Incoming goods inspection



Mount

Instruction of employees in production



Control

Quality control



Picking

Outgoing goods inspection

Measuring
Inspection
Check
Skeletonize
Positioning
Traffic control
Machine Learning
Test for completeness
Attendance control
Component inspection
Surface inspection
Number plate reading
3D matching
3D Vision
Robot Vision
Coplanarity
People entry control
Contour inspection
Contamination test
Defect detection
OCR / OCV
Barcode reading
DMC & QR Code reading
Thread inspection
Paper inspection
Plastic inspection
Metal inspection
Display inspection
Pattern matching
Blister inspection
Semiconductor industry
Food industry
Electrical industry
Pharmaceutical industry
Transport & Logistics
Stamping industry
etc.